

LAYOUT PLAN A

[Executive Room 1 / General manager 4seat / Staff 112seat]

Layout example [参考レイアウト]

デスクサイズ(mm) Desk size (mm)

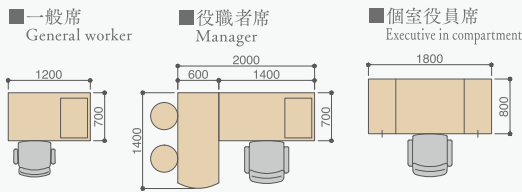

- 人数: 116名 (役員含む)
Number of workers :116 (includes executives)
- 一人当たりの面積: 5.72㎡/人
Area per worker : 5.72m² per person
- 打合せスペース: 6席×1 / 4席×3
Discussion booth : 6 seats x 1 / 4 seats x 3
- 個室: 6室 (社長室、給湯室、女子更衣室) 倉庫、サーバー室
Compartment : 6 rooms (per person (Director room, kitchenette, female dressing room, storage, server room))
- 会議室: 3室 24席 (12名×1、6名×2)
Meeting room : 3 rooms for total of 24 people (1 x 12 people, 2 x 6 people)
- 応接室: 3室 22席 (8名×2、6名×1)
Reception room : 3 rooms for total of 22 people (1 x 12 people, 2 x 6 people)

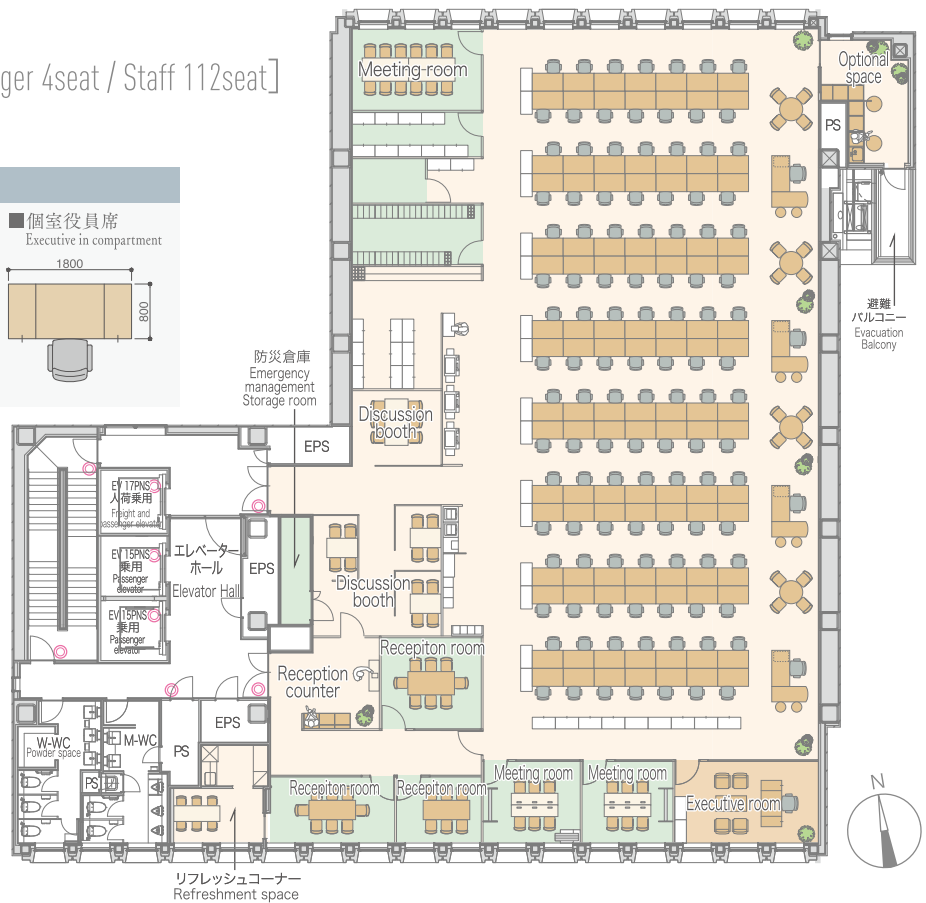

LAYOUT PLAN B

[Executive Room 1 / General manager 4seat / Staff 80seat]

Layout example [参考レイアウト]

デスクサイズ(mm) Desk size (mm)

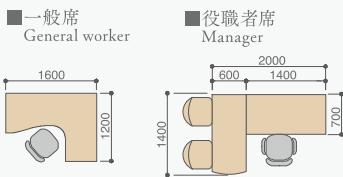

- 人数: 84名 (役員含む)
Number of workers :84 (includes executives)
- 一人当たりの面積: 5.72㎡/人
Area per worker : 5.72m² per person
- 打合せスペース: 6席×1 / 4席×3
Discussion booth : 6 seats x 1 / 4 seats x 3
- 個室: 6室 (社長室、給湯室、女子更衣室) 倉庫、サーバー室
Compartment : 6 rooms (per person (Director room, kitchenette, female dressing room, storage, server room))
- 会議室: 3室 24席 (12名×1、6名×2)
Meeting room : 3 rooms for total of 24 people (1 x 12 people, 2 x 6 people)
- 応接室: 3室 22席 (8名×2、6名×1)
Reception room : 3 rooms for total of 22 people (1 x 12 people, 2 x 6 people)



事務所(執務エリア) Lorem ipsum dolor sit amet.
 社長室 Director room.
 応接室・会議室・更衣室・サーバー室・倉庫 Reception room, meeting room, dressing room, server room, storage room
 ICカードシステム IC card security system

※排煙計算について別途確認が必要です。 ※Separate calculation is necessary for smoke eliminating.